

# FLOS

03.6302.14BCB Black

## Spot Module Casambi integrated NEW

Designed by FLOS Architectural, 2020



Accent lighting LED module to be installed in The Running Magnet System. Built-in DC/DC electronic voltage converter.

Are you a professional and your project needs consulting and support?

[BOOK AN APPOINTMENT](#)

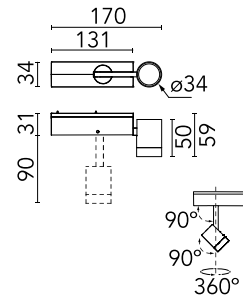

### Main specifications

Mounting	Track
Environments	Indoor dry location
Light Source Type	LED
LED type	Power LED
Lamp category	LED
Iicos	No
Bulb finish	Clear
Number of heads	1
Power (W)	8
System power (W)	8.4
System flux (lm)	418
Efficacy (lm/W)	49.76

### Physical

Colour	Black
Trim	No
Orientation	Adjustable
Rotation (°)	360
Longitudinal tilting (°)	90
Spot diameter (mm)	34
Length (mm)	34
Net weight (kg)	0.19
IP internal	20
IP external	20

### Download

[Mounting instructions](#)  PDF

### Photometric Files

[LDT / IES](#)  ZIP

### Technical Drawings

[2D](#)  ZIP

[3D](#)  ZIP

[Bim](#)  ZIP

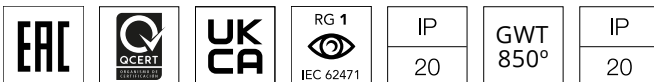

## Schematic light drawing

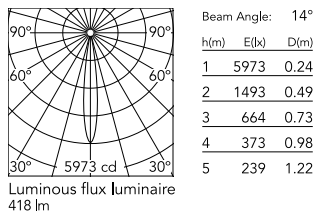

### Photometric

Lighting type	Direct
Light distribution	Symmetric
CCT (K)	3000
CRI>	90
McAdam steps (SDCM)	3
LED Life / Failure Ratio	L80B50
Beam angle C0-180 (°)	14
Beam angle C90-270 (°)	14
UGR <sub>L</sub>	14

### Electrical

Insulation class	III
Main voltage (Vac)	24
Forward voltage (V)	24
Driver	Remote excluded
Dimmable	Yes
Dimming type	Dimmable Casambi
Dimming range (%)	1-100

### Notes

Maximum 21 spots for a single driver. The control system with the Casambi version of light fixtures is directly and individually regulated wirelessly using the application FLOS Control® by Casambi. For the sizing of the installation keep a safety margin of 15% of the maximum power of the LED power source.

## Accessories & Power Supply



OPTIONAL  
Accessory

Optical

08.8427.14

Screening external ring for  
Running Magnet spot module



OPTIONAL  
Accessory

Optical

08.8759.00

Elliptical lens



OPTIONAL  
Accessory

Optical

08.8760.00

Frosted Medium lens



OPTIONAL  
Accessory

Optical

08.8761.00

Frosted Flood lens